



LOMCO STEEL

Oil & Gas

Oil & Gas

OMC Steel (Olympic Manufacturing Co.) products for compression solutions. We can help you in your process by supplying you with skids and other accessories according to your needs so that you can finish your compression product faster and at a more competitive price. If you produce compression packages we are your solution.

We are your supplier!

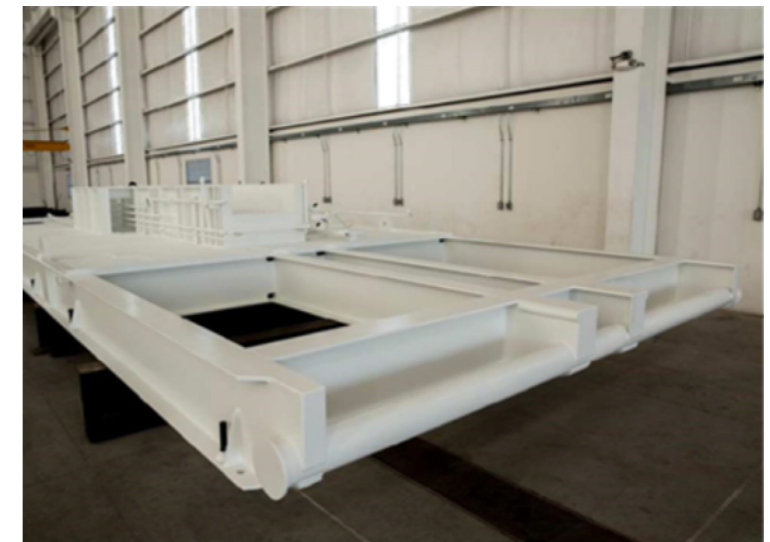
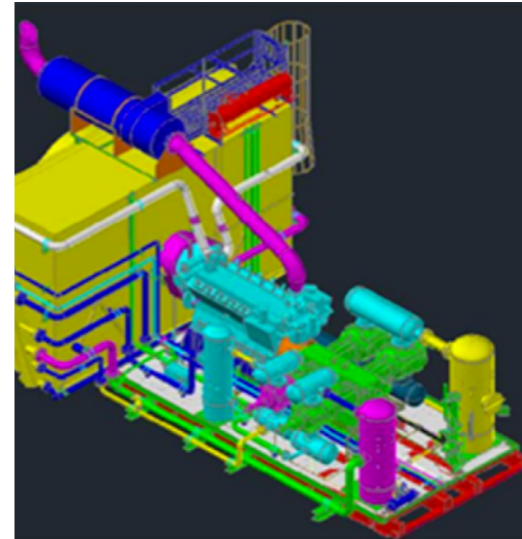

Compressor Package Products



ASME



CERTIFICATE OF AUTHORIZATION

The named company is authorized by the American Society of Mechanical Engineers (ASME) for the scope of activity shown below in accordance with the applicable rules of the ASME Boiler and Pressure Vessel Code. The use of the certification mark and the authority granted by this Certificate of Authorization are subject to the provisions of the agreement set forth in the application. Any construction stamped with this certification mark shall have been built strictly in accordance with the provisions of the ASME Boiler and Pressure Vessel Code.

COMPANY:

OLYMPIC MANUFACTURING S. DE R.L. DE C.V.
Carretera a Miguel Aleman Km 26.5
Apodaca, Nuevo Leon CP 66600
Mexico

SCOPE:

Manufacture of pressure vessels at the above location and field sites controlled by the above location (This authorization does not cover impregnated graphite)

AUTHORIZED:

June 8, 2018

EXPIRES:

February 2, 2021

CERTIFICATE NUMBER:

42,303

The American Society of Mechanical Engineers



Richard Stevenson
Board Chair, Conformity Assessment

Joseph Abadian
Managing Director, Conformity Assessment



Quality

Quality and Delivery are our priority. We become a part of our customers team and we work together to improve the performance and quality of the products we supply.



We assure your products quality



Main Building



Production

- Amada Laser Machine
- Wysong Press Brake
- Wysong Shear Machine
- Marvel Band Saw
- 60' X 22' Shot blasting booth
- 90' x 22' Liquid paint booth
- 25'x 10' Powder coating booth
- Ficep Steel beam profiler



Ficep Steel Beam Profiler



Laser Cutting

We serve as a strategic source for quality laser cut of industrial, commercial and architectural components and fabrications.

Whether you require prototype work or production runs, we are the one stop source for all your custom manufacturing needs.

Our laser systems include nesting capabilities for optimum work piece positioning, and flying optics that enhance the laser's multi-axis machining abilities.



Shot Blasting

Surface finishing technique that involves rapidly impacting the surface of an object with a controlled stream of abrasive shot material.

We have experience in the field of surface preparation, and our process controls are your assurance that shotblasted parts will maintain consistency, repeatability and uniformity.

60' x 22' booth



Paint Services

Let OMC Steel hand your surface preparation and painting needs. We have the equipment and we have the experience.

90' x 22' booth



New Facilities

We have started operations in our new facilities, with the new buildings our capacity duplicated, providing 80,000 sf of roofed area.





Some of our customers





DOMC STEEL

Established 1995